

7/8" EIA Flange Connector For 7/8" Foam Feeder Cable (78EIA-J7/8A)

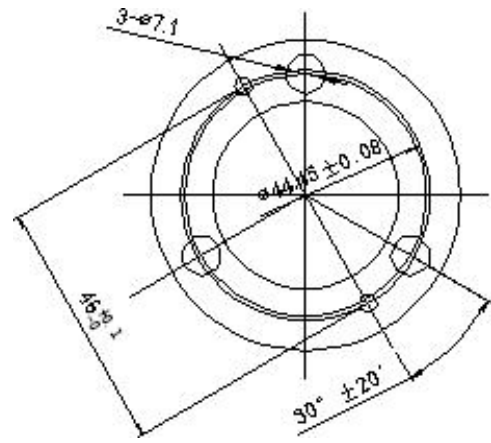
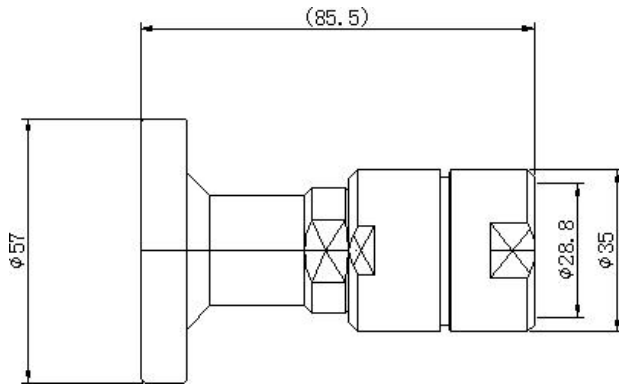

Interface

According to

7/8" EIA Flange

Electrical

Characteristic Impedance

50 ohm

Operating Frequency Range

DC-5GHz

VSWR

≤ 1.07 @DC-1000MHz; ≤ 1.25 @DC-2500MHz;

Dielectric Withstanding Voltage

≥ 6000 V RMS,50Hz,at sea level

Dielectric Resistance

≥ 5000 M Ω

Average Power

2.3KW@900MHz

Peak Power Maximum

90KW

Contact Resistance

Center Contact ≤ 1.5 m Ω

Outer Contact ≤ 1.5 m Ω

Mechanical

Durability

Mating cycles ≥ 100

Material and Plating

	Material	Plating
Body	Brass	Ni
Insulator	PTFE	—
Center conductor	Phosphor bronze	Ag
Coupling nut	Brass	Ni
Cable clamp	Brass	Ni
Gasket	Silicone rubber	—
Hardware kits	Stainless steel	—

Environmental

Temperature Range

-40°C ~ +85°C

Waterproof Rate

IP 67

RoHS Compliant

Yes

Suited Cable: Andrew LDF5-50, AL5-50, RFS LCF78-50; Leoni 7/8" R, Hansen 7/8", Eupen EC5-50